

Novastar Vnnox - LED Display Configurator

With the user-friendly Config-Tool from Novastar, you can easily configure your LED display yourself. After entering the most important parameters, you will receive a clear summary - ideal for support in the initial planning phase.

IMPORTANT: Please delete the project again, as soon as you have completed the download.

<https://eu.vnnox.com/care>

User Name: DLX_LED

PWD: admin_2025!

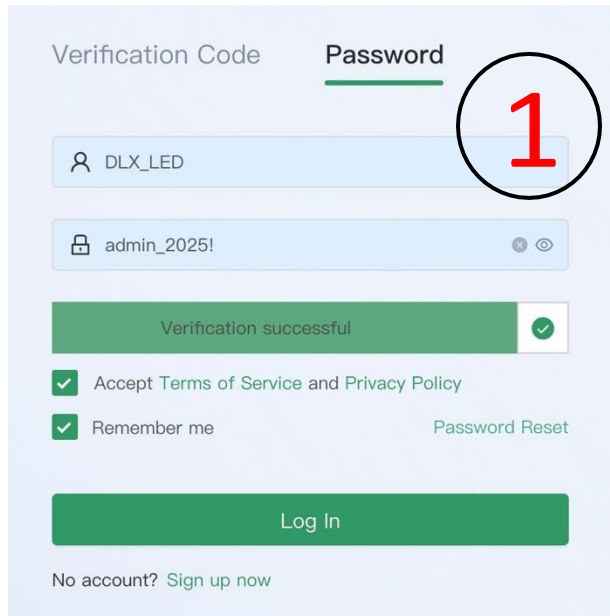

Verification Code Password

DLX_LED

admin_2025!

Verification successful

☒ Accept Terms of Service and Privacy Policy

☒ Remember me Password Reset

Log In

No account? [Sign up now](#)

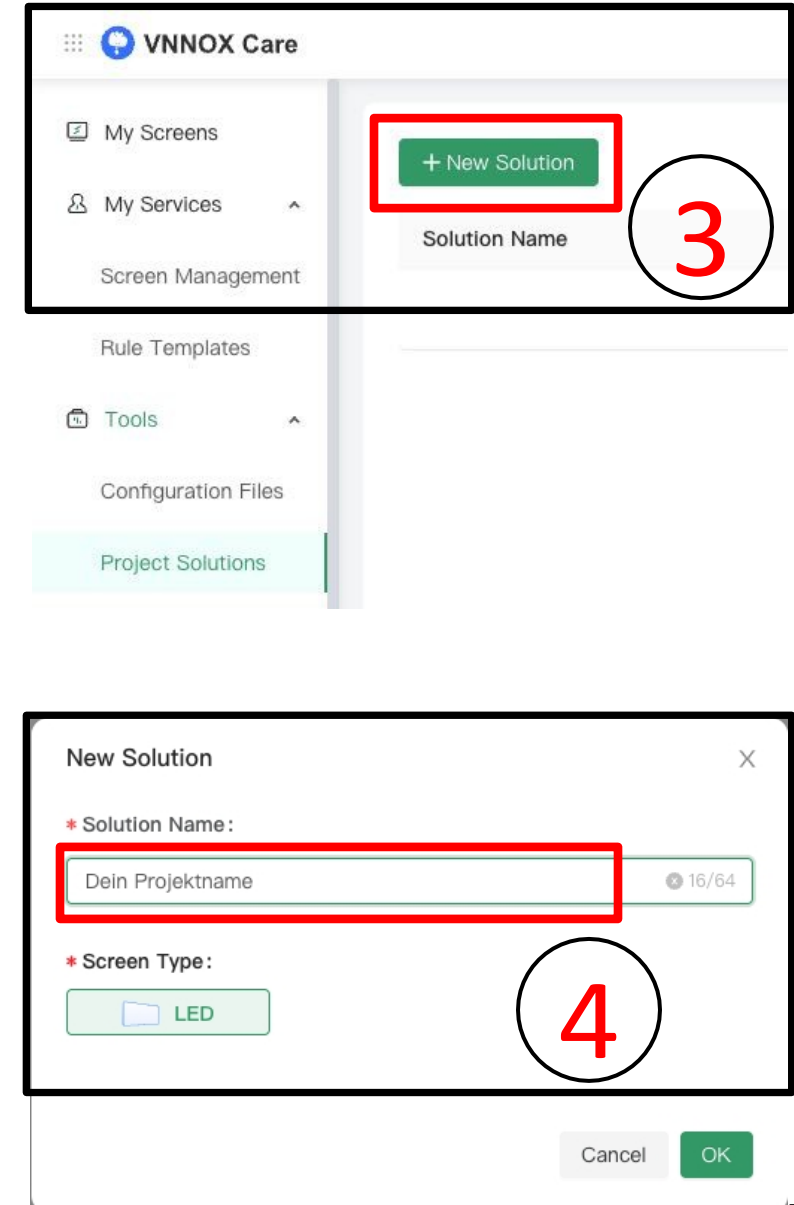
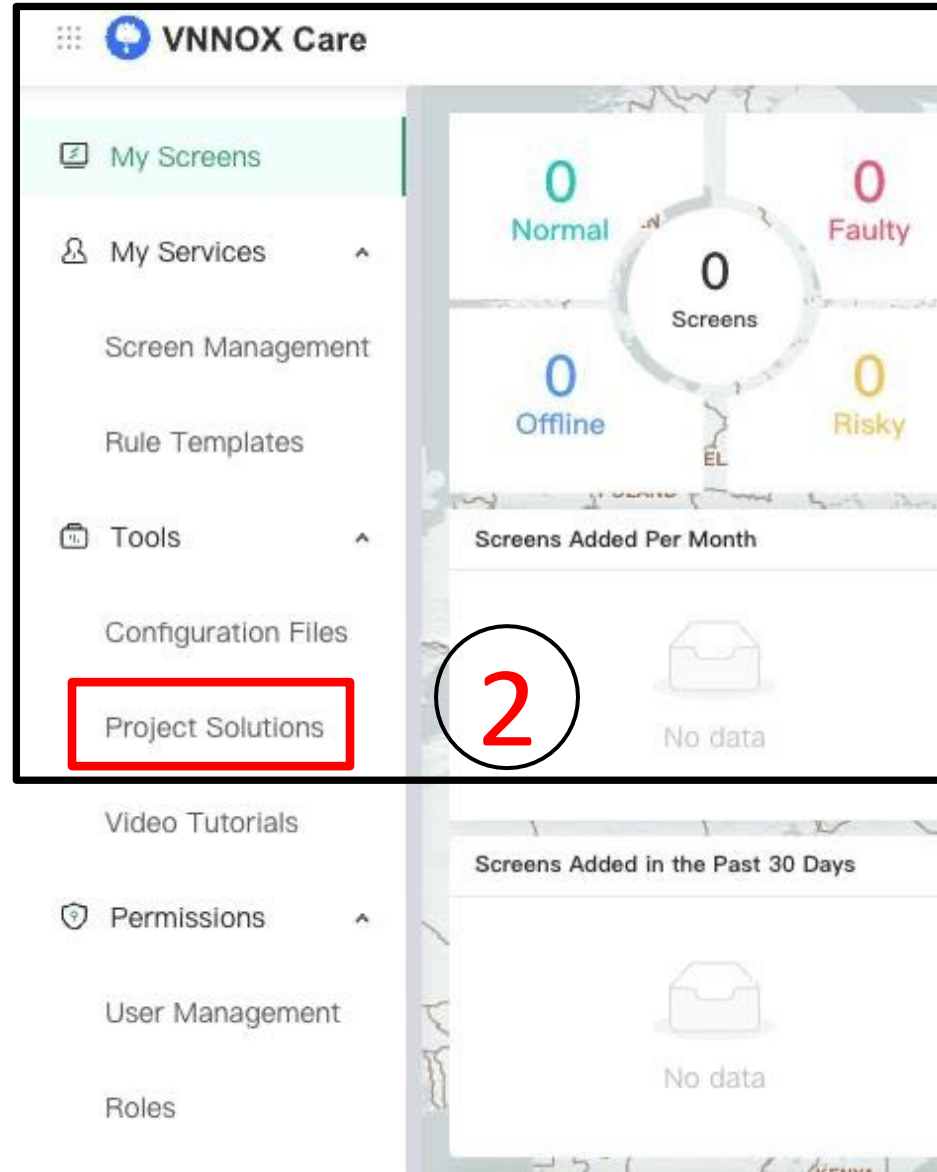

VNNOX Care

My Screens

My Services

Screen Management

Rule Templates

Tools

Configuration Files

Project Solutions

+ New Solution

Solution Name

Screens Added Per Month

Screens Added in the Past 30 Days

No data

No data

New Solution

* Solution Name:

Dein Projektname

* Screen Type:

LED

Cancel OK

Back

Hallenstation

Calculation Method *

Screen Size

Screen Resolution

Module/Cabinet Quantity

Aspect Ratio *

Custom

2:1

4:3

16:9

16:10

32:9

Width *

W: 3.6

m

Height *

H: 2.025

m

Total Area *

7.29

m²

Unit Type *

Module

Cabinet

Pixel Pitch * ⓘ

1.25

Dimensions (mm) *

600x337.5

Resolution (px) *

480x270

3.6m / 6W

Areas that are not covered

1.75m



2.025m / 6H

0.4m

0.105m

Actual Dimensions: 3.6x2.02 (m)

Resolution: 2880x1620 (px)

Actual Area: 7.27 (m²)

Total Pixels: 4.666 million (px)

Advanced Configuration (Optional)

Advanced Functions (Select All That Apply)

The system's default selected cabinet supports a frame rate of over 120Hz, a bit depth of over 10 bits and a refresh rate of over 120Hz. It is recommended to confirm with the screen manufacturer of industrial technology during actual use.

☐ Pixel to Pixel

☐ Video Source Preview

☐ Long-distance Transmission

☐ Multi-Layer

☐ Frame Frequency

☐ Bit Depth

Enter the desired parameters in this screen. There are numerous setting options available to you to determine the right size and resolution for your display

Additional options can be found here individually.

DLX_06.05.2

Advanced Configuration (Optional)

Advanced Functions (Select All That Apply)

The system's default selected cabinet supports a frame rate of over 120Hz, a bit depth of over 10 bits, 3D, and HDR. It is recommended to confirm with the screen manufacturer or Novastar Technology during actual use.

☐ Pixel to Pixel☐ Video Source Preview☐ Long-distance Transmission☐ Multi-Layer☐ Frame Frequency☐ Bit Depth☐ USB Playback☐ Active Shutter 3D☐ HDR☐ Remote Playback Control

Input Connectors (Specify the input connector type and quantity according to the signal source)

Common Connector Resolutions ⓘ



HDMI1.3

− 0 +



DVI

− 0 +



3G_SDI

− 0 +



VGA

− 0 +



CVBS

− 0 +



HDBaseT(2k60)

− 0 +



HDMI1.4

− 0 +



DP1.1

− 0 +



HDBaseT(4k30)

− 0 +



HDMI2.0

− 0 +



DP1.2

− 0 +



12G_SDI

− 0 +



NDI

− 0 +



RJ45 (IP decoding)

− 0 +



DP1.4

− 0 +



HDMI2.1

− 0 +



Video over IP

− 0 +



OPT

− 0 +



ST2110

− 0 +



Additional options can be added individually.

Next

< Back

Hallenstation

★HOT

Controller

TU4K Pro

Ethernet Cable

14

Smart Control

Software

VNNOX

COEX series

Controller

MX40 Pro

Software

VMP

Media Server

ET1S-G

Ethernet Cable

14

Dual Splicing

Host

H2

Software

VNNOX Care

Media Server

ET1S-G

Ethernet Cable

14

Splicer + Sender

Host

H2

Media Server

ET1S-G

Controller

MCTRL4K

Software

VNNOX Care

Solution Details

Controller

Product Name

TU4K Pro

Quantity

1

Capacity

13 million



Software

+ Add Software

VNNOX

Desktop PC

VNNOX Care

Mobile App/Web Cloud

NovaLCT

Desktop PC

Suitable peripherals are displayed here based on your settings, which you can then select yourself.

DLX_06.05.2



Full Screen

Download Connection Diagram

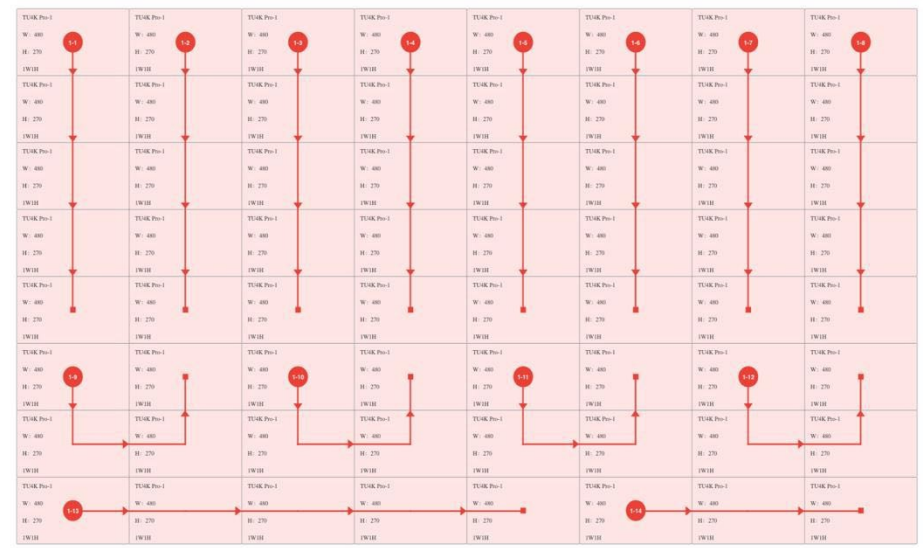

Full Screen

Download Connection Diagram

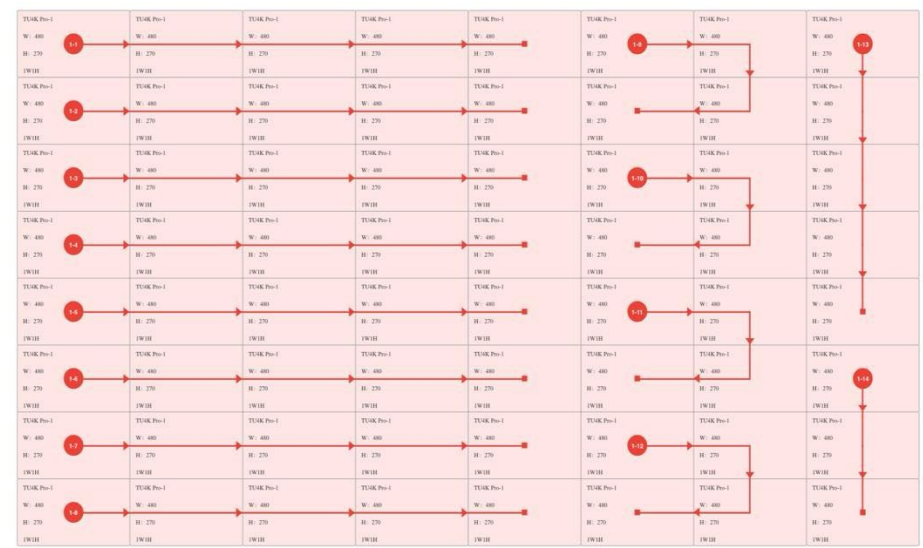

Full Screen

Download Connection Diagram

the cabling option best suits your installation on site from the suggested cabling options

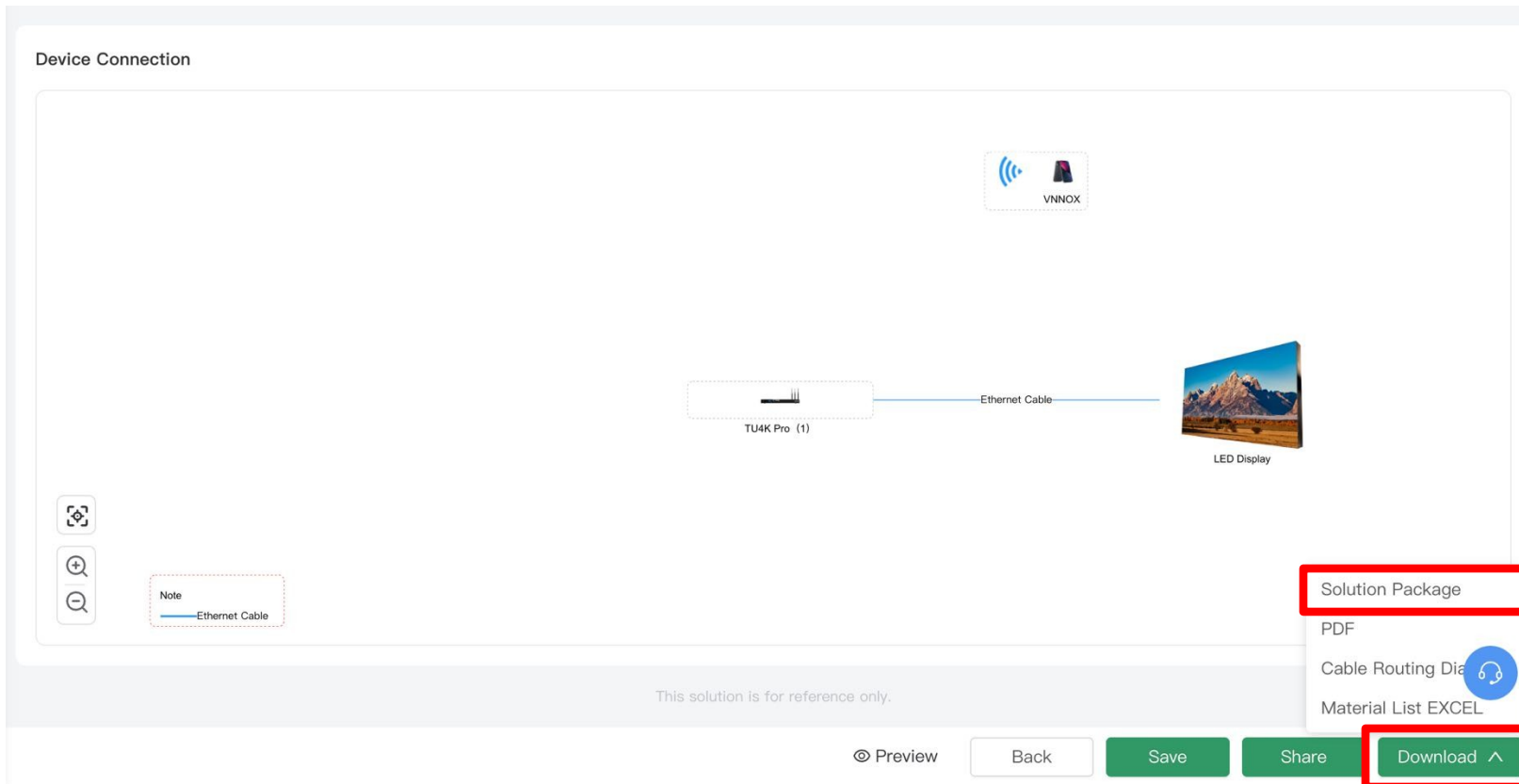

IMPORTANT: Please delete the project as soon as you have completed the download.

The connection of the devices is clearly visualized in a graphic.

All relevant data is available for download as a ZIP file and can be used directly for your project.

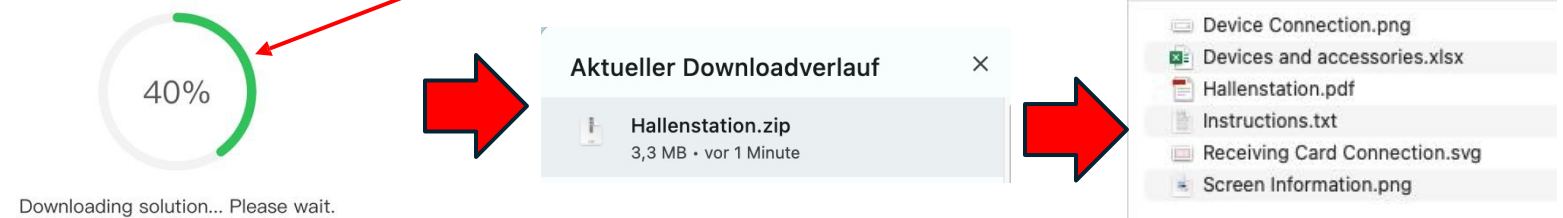

Send us this ZIP file and we will create a suitable offer for your project.